

CoE-IHS Office Hour:
New Resources to Advance Health Equity
through Integrated Health and Clinical Practice

Thursday, January 27th, 2022
1-2pm ET

Questions, Comments & Closed Captioning

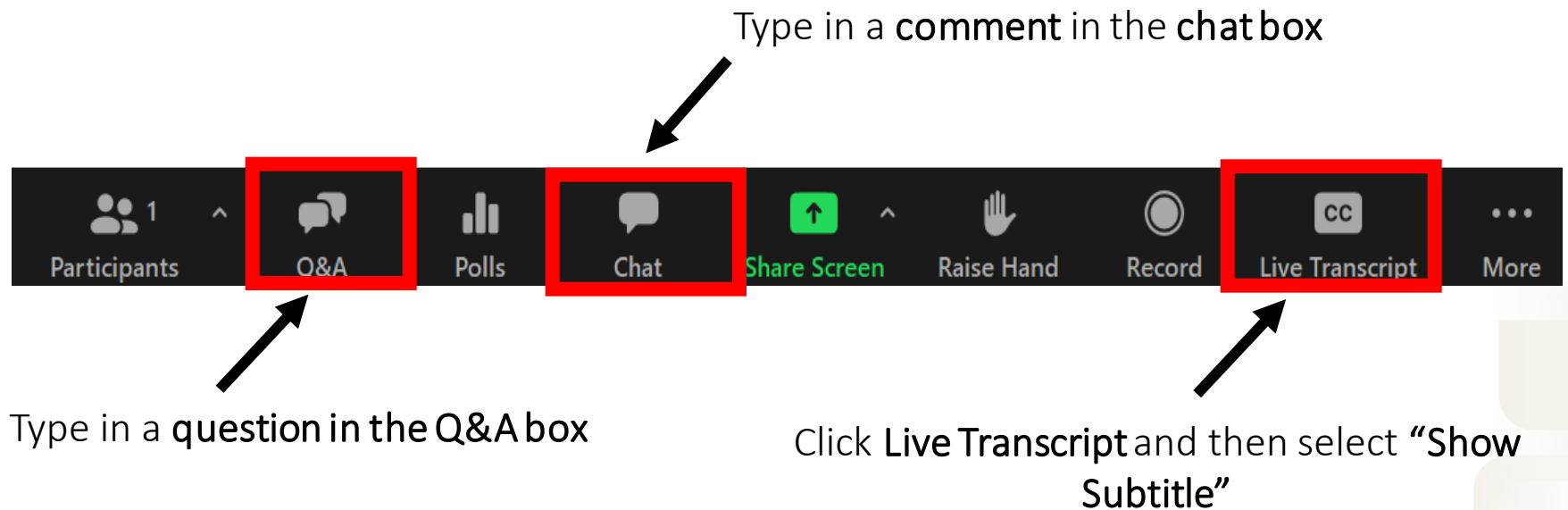

Disclaimer

The views, opinions, and content expressed in this presentation do not necessarily reflect the views, opinions, or policies of the Center for Mental Health Services (CMHS), the Substance Abuse and Mental Health Services Administration (SAMHSA), or the U.S. Department of Health and Human Services (HHS).

SAMHSA

Substance Abuse and Mental Health
Services Administration

www.samhsa.gov

NATIONAL
COUNCIL
for Mental
Wellbeing

Introductions

Moderator

- **Paula Zaremba**, *Project Manager*, Practice Improvement & Consulting, National Council for Mental Wellbeing

Panelists

- **Dr. Pierluigi Mancini**, *President*, Multicultural Development Institute
- **Dr. Terence Fitzgerald**, *Clinical Associate Professor*, University of Southern California
- **Sarah Neil**, *Director*, Practice Improvement & Consulting, National Council for Mental Wellbeing



NATIONAL
COUNCIL
for Mental
Wellbeing

Health Equity ECHO Series Launch



NEW ECHO: Advancing Health Equity through Integrated Care ECHO

This ECHO Learning Community will bring together a diverse group of experts and organizations for peer-to-peer learning and discussions with a group of health provider organizations who are committed to advancing equity for both clients and staff within their organizations to ultimately improve the access to and quality of health services provided to historically marginalized communities, through advancing integrated health and strengthening clinical and organizational practices. This ECHO will meet monthly for 6 months from February – July 2022.

[Click here](#) to learn more about the ECHO Model.

[Click here](#) to learn more and apply to the ECHO. Applications close on Friday, February 4th, 2022.

[Click here](#) to checkout our participant FAQ document.

Have questions? Contact integration@thenationalcouncil.org

Poll Question

Are you interested in participating in the Health Equity ECHO learning collaborative and receiving more information in the future?

- Yes, please send me more information.
- No, not at this time.

Tools & Resources

- [Access for Everyone: A Toolkit for Addressing Health Equity & Racial Justice within Integrated Care Settings](#)
- [Health & Racial Equity List of Definitions](#)
- [Racial Equity Tools](#)
- [Diversity, Equity & Inclusion Framework](#)
- [Racial Equity Toolkit](#)
- **Recent Office Hour Sessions:**
 - [Advancing Health Equity Starts with Us](#) (July 2021)
 - [Returning to the Office? Equitable Considerations & Implications](#) (August 2021)
 - [Workforce Shortages & Impact on BIPOC Providers & Staff](#) (September 2021)
 - [Supporting the Wellbeing of LGBTQ+ Clients and Staff: Intersectional and Affirming Strategies](#) (October 2021)
 - [Introducing an Innovative Toolkit to Advance Health Equity in Integrated Care Settings](#) (November 2021)
 - [Understand Health Inequities, Health Disparities & Social Determinants of Health within Integrated Care Settings](#) (December 2021)



Health Equity and Racial Justice Webpage

National Council for Mental Wellbeing

See our page for more information on Webinars and Upcoming Events, Resources and Tools, and Training and Technical Assistance focused on Health Equity and Racial Justice

NATIONAL
COUNCIL
for Mental
Wellbeing



Upcoming CoE Events:

CoE Office Hour: Transforming Care Delivery & Addressing the Workforce Shortage through Short-term Policy Action

[Register for the office hour](#) on Monday, January 31, 1-2pm ET

Interested in an individual consultation with the CoE experts on integrated care?

[Contact us through this form here!](#)

Looking for free trainings and credits?

[Check out integrated health trainings from Relias here](#)

Subscribe for Center of Excellence Updates

[Subscribe here](#)

NATIONAL
COUNCIL
for Mental
Wellbeing



Thank You

Questions?

Email integration@thenationalcouncil.org

SAMHSA's Mission is to reduce the impact of substance abuse and mental illness on America's communities.

www.samhsa.gov

1-877-SAMHSA-7 (1-877-726-4727) 1-800-487-4889 (TDD)