

CoE-IHS Office Hour:  
Understanding Black & African American  
Experiences in Mental Health & Substance Use  
Treatment Services

Thursday, February 17th, 2022  
3-4pm ET

**CENTER OF EXCELLENCE** for Integrated Health Solutions

Funded by Substance Abuse and Mental Health Services Administration and operated by the National Council for Mental Wellbeing

# Questions, Comments & Closed Captioning

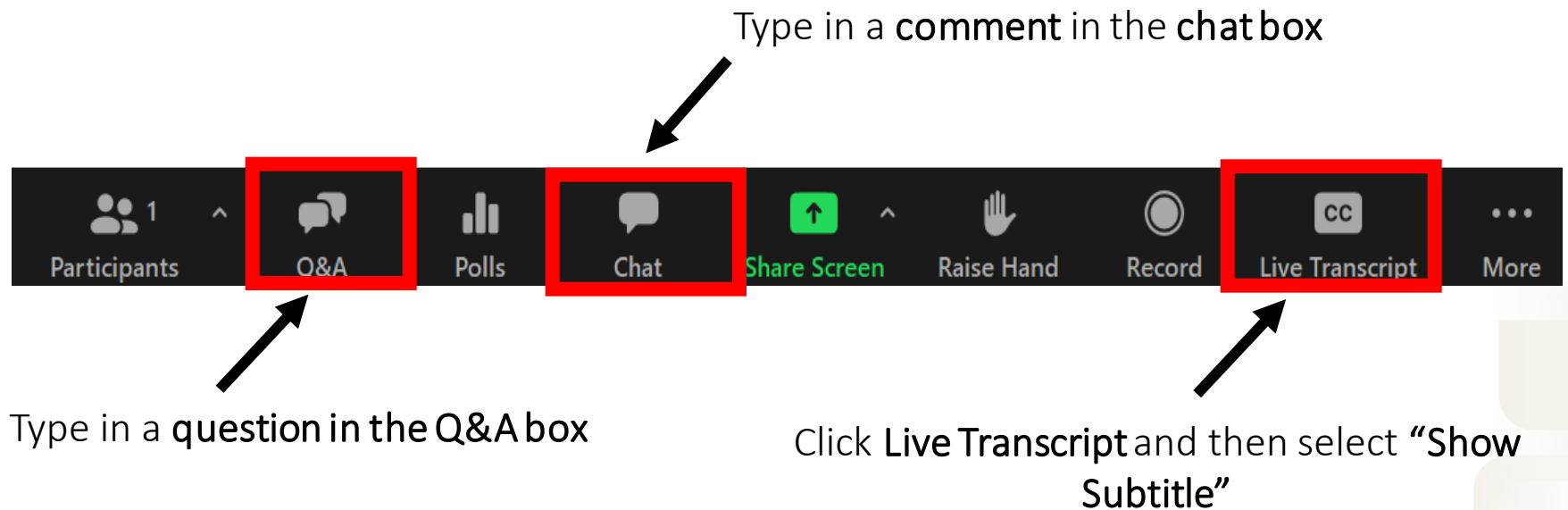

# Disclaimer

The views, opinions, and content expressed in this presentation do not necessarily reflect the views, opinions, or policies of the Center for Mental Health Services (CMHS), the Substance Abuse and Mental Health Services Administration (SAMHSA), or the U.S. Department of Health and Human Services (HHS).

***SAMHSA***

Substance Abuse and Mental Health  
Services Administration

[www.samhsa.gov](http://www.samhsa.gov)

NATIONAL  
COUNCIL  
*for* Mental  
Wellbeing



# Introductions

## Moderator

- **Aaron Williams**, *Senior Advisor*, Practice Improvement & Consulting, National Council

## Panelists

- **Dr. Ami Roeschlein**, *Consultant*, Practice Improvement & Consulting, National Council
- **Dr. Pierluigi Mancini**, *President*, Multicultural Development Institute
- **Dr. Terence Fitzgerald**, *Clinical Associate Professor*, University of Southern California
- **Dr. Kaleea Lewis**, *Assistant Professor*, University of Missouri – Columbia



NATIONAL  
COUNCIL  
*for* Mental  
Wellbeing



# Tools & Resources

- [Addressing Disparities in Access and Utilization of Mental Health and Substance Use Services Among Blacks and African Americans: Solutions from Community Stakeholders](#)
- [Access for Everyone: A Toolkit for Addressing Health Equity & Racial Justice within Integrated Care Settings](#)
- [Social Justice Leadership Academy \(SJLA\) Workbook](#)
- [Racial Equity Tools](#)
- [Diversity, Equity & Inclusion Framework](#)
- [Racial Equity Toolkit](#)



## Recent Office Hour Sessions:

- [Workforce Shortages & Impact on BIPOC Providers & Staff](#) (September 2021)
- [Supporting the Wellbeing of LGBTQ+ Clients and Staff](#) (October 2021)
- [Toolkit to Advance Health Equity in Integrated Care Settings](#) (November 2021)
- [Understand Health Inequities, Health Disparities & Social Determinants of Health](#) (December 2021)
- [Resources to Advance Health Equity through Integrated Health](#) (January 2022)



# Additional Tools & Resources

## National Council for Mental Wellbeing – Blog Posts

- [Furthering the Wellbeing of Black, Indigenous & People of Color through Integrated Care](#)
- [During Black History Month, Let's Commit Ourselves to Improving the Mental Health of Black Americans](#)
- [Moving Forward this Black History Month – Setting Youth Up for Success](#)

## Other

- Mental Health America – [Black History Month](#)
- Federal Emergency Management Agency (FEMA) - [2022 Black Health & Wellness](#)
- [Black Mental Health Alliance](#)

### [Health Equity and Racial Justice Webpage](#)

*National Council for Mental Wellbeing*

*See our page for more information on Webinars and Upcoming Events, Resources and Tools, and Training and Technical Assistance focused on Health Equity and Racial Justice*

NATIONAL  
COUNCIL  
for Mental  
Wellbeing



# Upcoming CoE Events:

Integrated Care: Charting a Path Forward

[Register for the webinar](#) on Thursday, February 24, 1-2pm ET

Advancing General Health Integration in Behavioral Health: Mid-Year Findings

[Register for the webinar](#) on Monday, February 28, 12-1pm ET

Interested in an individual consultation with the CoE experts on integrated care?

[Contact us through this form here!](#)

Looking for free trainings and credits?

[Check out integrated health trainings from Relias here](#)

Subscribe for Center of Excellence Updates

[Subscribe here](#)

NATIONAL  
COUNCIL  
for Mental  
Wellbeing



# Thank You

## Questions?

Email [integration@thenationalcouncil.org](mailto:integration@thenationalcouncil.org)

SAMHSA's Mission is to reduce the impact of substance abuse and mental illness on America's communities.

**[www.samhsa.gov](http://www.samhsa.gov)**

1-877-SAMHSA-7 (1-877-726-4727) 1-800-487-4889 (TDD)

