

CoE-IHS Office Hour:
Resources for Advancing Oral Health
Coordination and Integration

Tuesday, January 25, 2022
3-4pm ET

CENTER OF EXCELLENCE for Integrated Health Solutions

Funded by Substance Abuse and Mental Health Services Administration and operated by the National Council for Mental Wellbeing

Questions, Comments & Closed Captioning

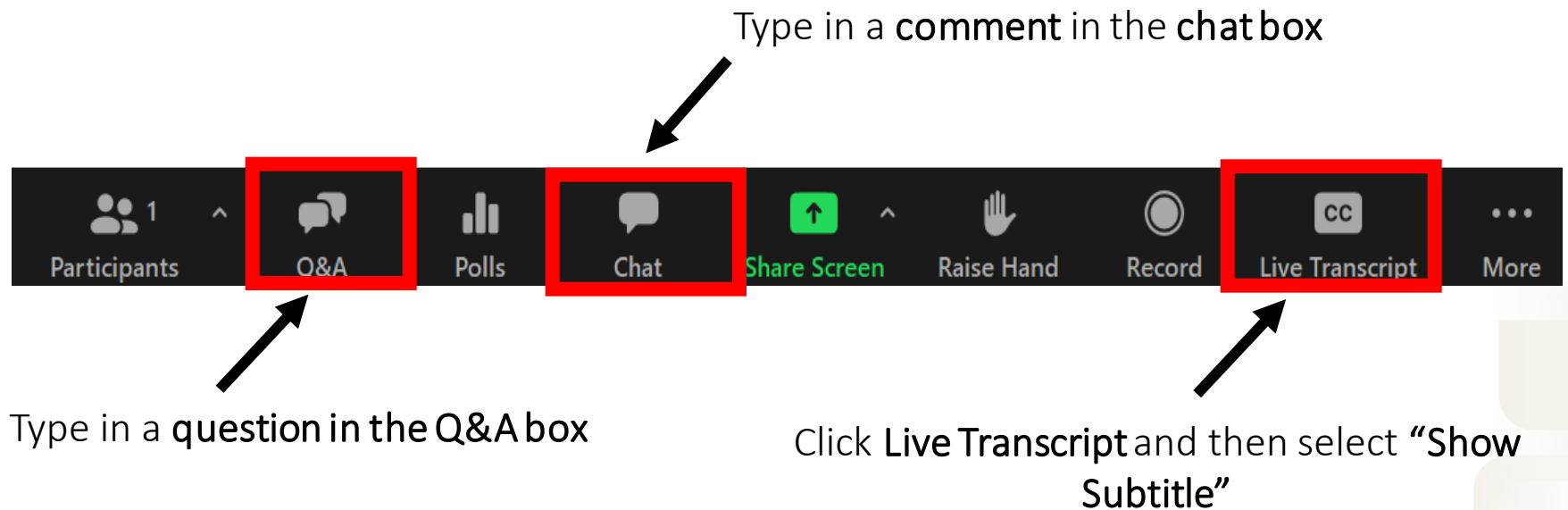

Disclaimer

The views, opinions, and content expressed in this presentation do not necessarily reflect the views, opinions, or policies of the Center for Mental Health Services (CMHS), the Substance Abuse and Mental Health Services Administration (SAMHSA), or the U.S. Department of Health and Human Services (HHS).

SAMHSA

Substance Abuse and Mental Health
Services Administration

www.samhsa.gov

NATIONAL
COUNCIL
for Mental
Wellbeing

Introductions

Moderator

- **Sarah Neil**, *Director*, Practice Improvement & Consulting, National Council for Mental Wellbeing

Panelists & Participating Organizations

- **Rachael Matulis**, Principal, Bowling Business Strategies
- **Dr. Irene Hilton**, Dental Consultant, National Network for Oral Health Access
- **Stacey Chazin**, Principal, Stacey Chazin Consulting & Recent Director of Capacity Building & Technical Assistance, Oral Health Progress & Equity Network



NATIONAL
COUNCIL
for Mental
Wellbeing



Oral Health Integration ECHO



-
- [Application Form](#)
 - [FAQ's](#)
 - [Download the framework](#)

The goal of this ECHO is to engage diverse stakeholders and mental health and substance use treatment organizations in an interactive peer-to-peer learning environment geared towards advancing the coordination and integration of oral health, mental health and substance use care while increasing access to care for marginalized populations living with mental health and substance use challenges.

Application deadline: Friday, January 28th, 11:59 PM ET.

Tools & Resources

- [Oral Health, Mental Health & Substance Use Treatment: A Framework for Increased Coordination & Integration](#)
- [Environmental Scan of Oral Health Integration Models](#)
- [Trauma-Informed Care and Oral Health: Recommendations for Practitioners](#)
- [American Dental Association, Medications that Cause Dry Mouth](#)
- [Oregon Oral Health Coalition](#)
- [Oral Health Care Tips for Children with Developmental or Behavior Concerns](#)
- [A Framework for Stratifying Race, Ethnicity and Language Data](#)
- [Oral Health Risk Assessment Tool](#)
- [Oregon Oral Health Coalition's Oral Health Toolkit](#)

Previous Events

- Oral Health, Mental Health & Substance Use Treatment Integration: Toolkit to Action – [slides & recording](#)



Upcoming CoE Events:

CoE Office Hour: New Resources to Advance Health Equity through Integrated Health & Clinical Practice

[Register for the office hour](#) on Thursday, January 27, 1-2pm ET

CoE Office Hour: Transforming Care Delivery & Addressing the Workforce Shortage through Short-term Policy Action

[Register for the office hour](#) on Monday, January 31, 1-2pm ET

Interested in an individual consultation with the CoE experts on integrated care?
[Contact us through this form here!](#)

Looking for free trainings and credits?
[Check out integrated health trainings from Relias here](#)

Subscribe for Center of Excellence Updates
[Subscribe here](#)

NATIONAL
COUNCIL
for Mental
Wellbeing



Thank You

Questions?

Email integration@thenationalcouncil.org

SAMHSA's Mission is to reduce the impact of substance abuse and mental illness on America's communities.

www.samhsa.gov

1-877-SAMHSA-7 (1-877-726-4727) 1-800-487-4889 (TDD)